



Installation Instructions

Part No. 20-105/205/215/220/225/230/235/240/245 & 250

Tools Needed

Hammer, Center Punch
Drill Motor
1/8" Drill Bit
Pliers
#2 Phillips Screwdriver
Tape Measure
Masking Tape

Parts List

5..... Hi-Five® Lights (3 Units in Hi-Five® Kits: 20-240, 20-250)
1..... Switch
2..... Short sheet metal screws (not included in: 20-240, 20-250)
1..... Pig tail with fuse
1..... Length of red wire
10..... Long sheet metal screws
6..... Quick Splice Connectors

NOTE:
Check kit contents before beginning installation.

CAUTION! BEFORE BEGINNING INSTALLATION OF YOUR PACER HI-FIVE® LIGHTS, READ INSTRUCTIONS THROUGH CAREFULLY AND COMPLETELY. BEFORE DRILLING, CHECK TO MAKE SURE ALL LIGHTS ARE POSITIONED AND LOCATED PROPERLY. USE MEASURING TAPE TO ENSURE ACCURACY AND MASKING TAPE TO MARK POSITIONS.

USING LIGHT AS TEMPLATE FOR MOUNTING AND THE DRILLING OF WIRING HOLES

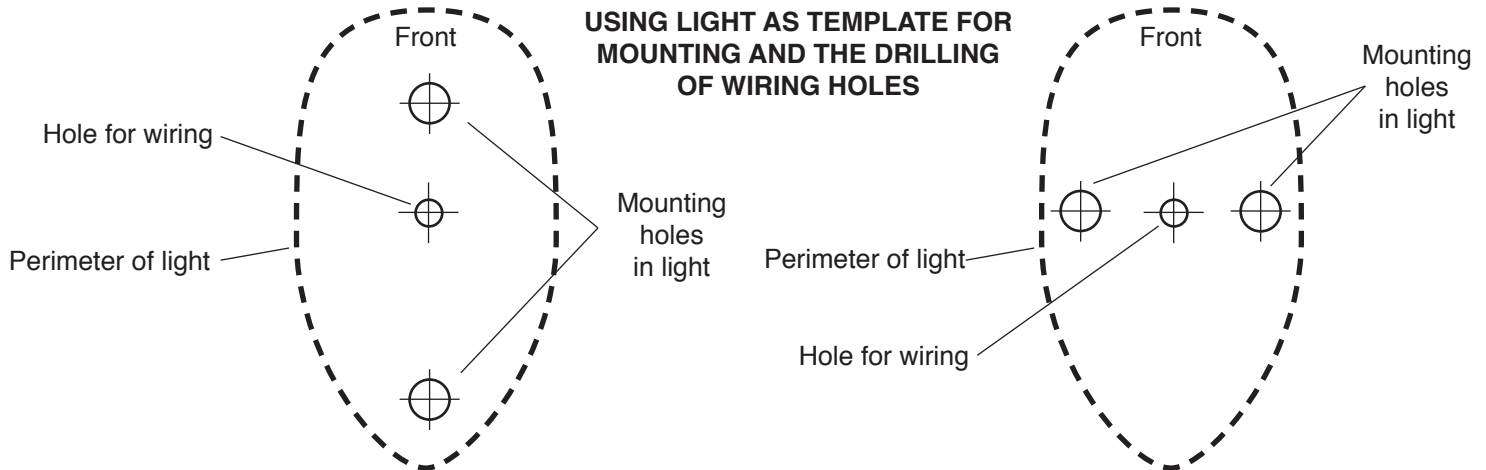

POSITIONING LIGHTS & TOGGLE SWITCH

1) Determine best location for light placement, using a tape measure to make sure lights are positioned and spaced evenly. Use masking tape to mark the position of the lights. Always find absolute center first, attaching and securing that light first. Measure outward from there. NOTE: On all roof mount installations, use of amber lights/lenses can be forward-facing. Use of red lights/lenses MUST be positioned with lights facing rearward.

2) Working inside vehicle, determine best placement for toggle switch. Keep in mind your natural seating position as well as placing switch within easy reaching distance.

MOUNTING LIGHTS AND TOGGLE SWITCH

1) On roof mount installations, working inside vehicle, lower headliner directly below desired mounting area to access inside where mounting screws and light wiring will pass through and into cab.

2) Using light lens as a template, mark location of both mounting holes onto roof. Mark around lens on masking tape stuck to

roof. Move lens, then mark location of hole needed for wiring to pass through roof. Make sure hole is inside the perimeter of the light (see diagram) and allows easy routing for the wire.

3) CAREFULLY center punch marked hole locations. Only a light tap of the hammer is necessary to dimple sheet metal.

4) Before drilling, make sure headliner is clear and will not be pierced by drill bit. Now drill holes marked using 1/8" bit.

5) Drill small hole in gasket corresponding to hole for wiring, then push wiring down through center hole. Attach and secure lens/gasket assembly to roof using long sheet metal screws provided in hardware bag. Repeat procedure for all lights.

6) Position toggle switch in area clear of obstructions that will not interfere with leg or arm/hand motions, but is within easy reaching distance of driver's seat. Using slots at top of plastic switch housing as a template, mark location to be drilled for mounting. Carefully drill where marked using 1/8" drill bit. Attach and secure switch using small sheet metal screws provided.

SEE REVERSE SIDE FOR WIRING INSTRUCTIONS

Warning:

Installation of motor vehicle accessories should only be undertaken by those with mechanical knowledge who are familiar with working on vehicles. ALWAYS use eye protection (goggles, safety glasses or shield). Park the vehicle in a well lit area, on level ground and apply the parking brake. Disconnect the battery before beginning. After installation, reconnect battery and check all lights and electronic functions thoroughly. Failure to follow instructions can lead to severe damage and personal injury.

**HI-FIVE® WIRING DIAGRAM FOR;
20-105, 20-205, 20-215, 20-220, 20-225, 20-230, 20-235, 20-245**

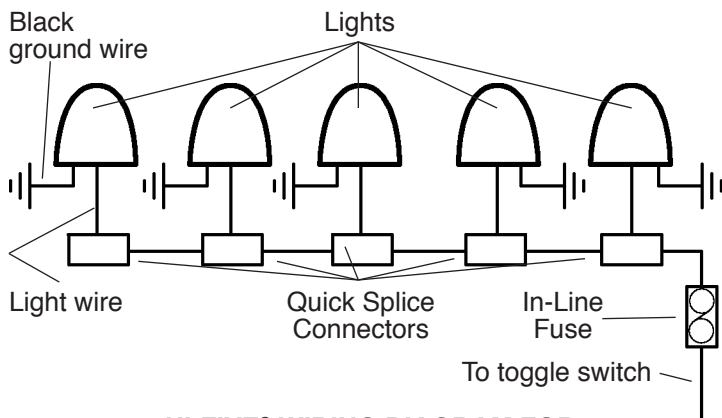

**HI-FIVE® WIRING DIAGRAM FOR;
20-240 AND 20-250**

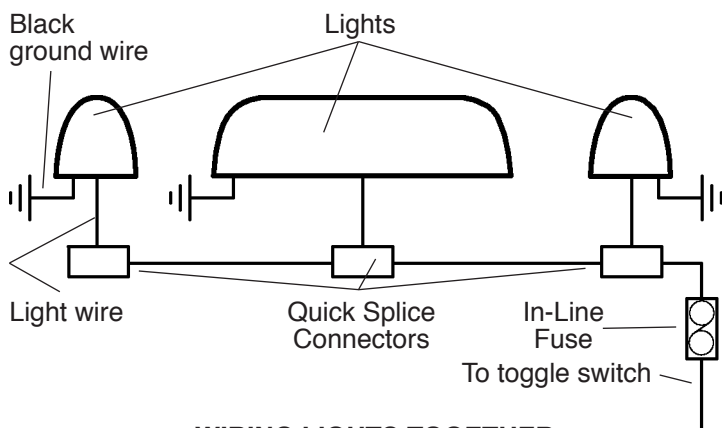

WIRING LIGHTS TOGETHER

Beginning with lights located farthest from switch, splice light wire to end of red wire (end without connector) using quick splice connectors provided. After inserting both wires, fold over connector and press tightly using hand pliers. Continue with each light in sequence. Tape all wires securely to roof when finished.

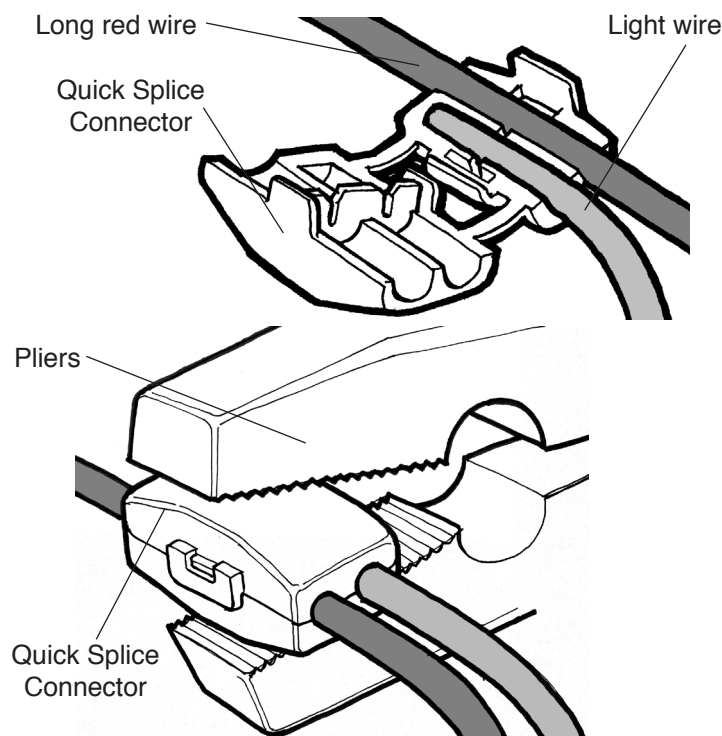

WIRING of TOGGLE SWITCH

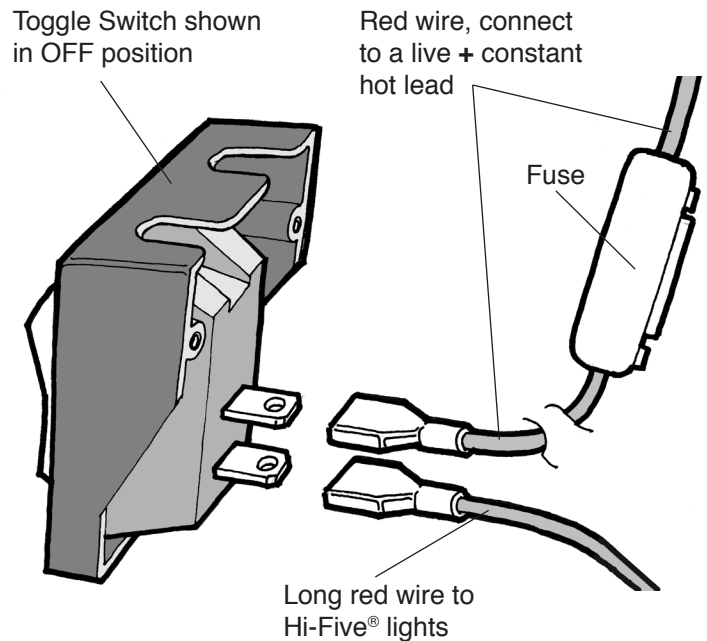

WIRING LIGHTS TO TOGGLE SWITCH

- 1) Route connector end of red wire to switch, running wiring either inside or alongside windshield pillar for OE look.
- 2) Connect red wire to bottom plug on backside of switch. (See diagram)
- 3) Attach red hot wire with fuse to top plug on backside of switch. (See diagram). The stripped end of red wire can now be spliced into a constant hot lead. This will allow lights to operate directly with switch, independent of the vehicle's lights.
- 4) Attach each individual negative wire to one of the mounting screws, assuring that it is making proper contact. Ground wires may also be spliced together and connected to a good chassis ground.

NOTE: IF LIGHTS DO NOT WORK AFTER MOUNTING:

- 1) Remove plastic lens and check to make sure bulb is correctly installed and the filament is intact.
- 2) Check the ground wire for each light has a clean connection.
- 3) Check in-line fuse to make sure it is secure and in working order.
- 4) Recheck all connections to make sure they are secure.
- 5) Check hot lead at fuse box to make sure power source is constant.