

# WeatherTech®

## No-Drill MudFlap

### Installation Instructions

Thank you for purchasing the WeatherTech® No-Drill MudFlap. Please read this installation guide to thoroughly familiarize yourself with the steps to install the MudFlap on your vehicle. When properly installed, the WeatherTech® No-Drill MudFlap will provide you with years of protection.



- Small Flatblade
- Razor knife
- 7/16" box end wrench
- Stubby Phillips Screwdriver

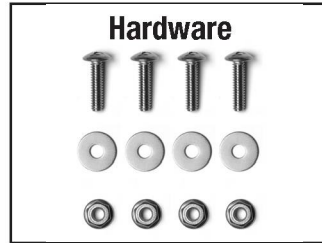

- Parts Kit (T)
- (4) 12 x 24 x 3/4" Phillips head bolts
  - (4) 12 x 24 Serrated Locknuts
  - (4) 3/4" Washers

**⚠ WARNING ⚠**

The MudFlap is designed to fit vehicles with standard size wheels and tires. Installation of MudFlaps on vehicles with aftermarket wheels or oversize tires may interfere with the MudFlap, will void the warranty and may damage the MudFlap or the vehicle.

- 1** Start by thoroughly washing your vehicle. Take care to remove all dirt, debris, and stains from each fender in the areas corresponding to where the MudFlaps will be installed.

- 2** Park the vehicle on level ground and begin with the driver's side MudFlap installation.

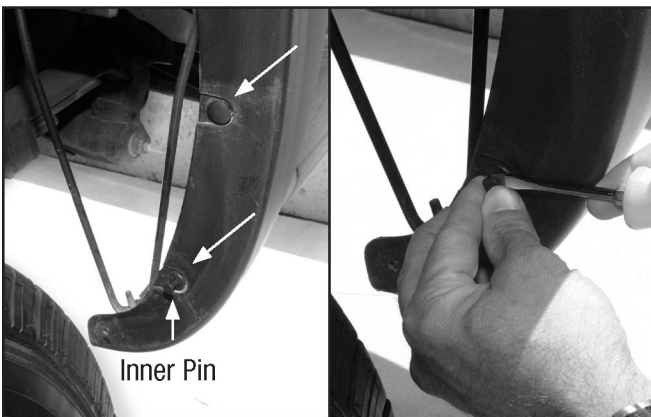

- 3** Begin by locating the (2) plastic rivets shown. Use a small flat blade screwdriver to carefully remove the inner portion (pin) of the lower plastic rivet indicated. When the inner portion is removed, you will be able to remove the outer portion of the rivet.

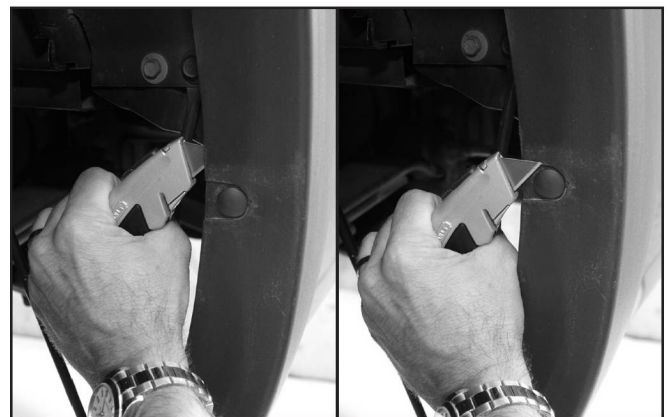

- 4** For the upper rivet, it might be necessary to cut off the back and/or front of the rivet for removal.

[View Easy Installation Video](http://WeatherTech.com/install)  
[WeatherTech.com/install](http://WeatherTech.com/install)

Questions? Call customer service at 630 769 1500  
Monday - Friday: 9 a.m. to 5 p.m. Central Time



**5** You will now have (2) exposed holes for mounting.

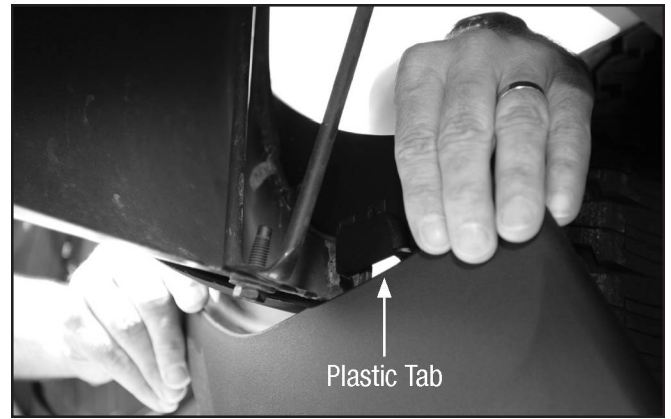

**6** Please note the plastic tab located on the bottom portion of the MudFlap. This tab will be used to hook around and hold onto the bottom of the fender lip of the vehicle.



**7** While holding the MudFlap at approximately 45° from vertical, hook the plastic tab on the MudFlap around the inside corner of the fender lip. When the lip edge has been hooked, rotate the MudFlap up into position on the edge of the fender. The MudFlap will fit perfectly to the contour of the fender.



**8** The slots in the MudFlap will line up with the holes in the fender.



**9** Use the supplied bolts and washers to attach the MudFlap. Before tightening, press the MudFlap against fender flare to assure a tight fit. Hand tighten the fasteners.

**10** Repeat steps 3-9 for the passenger side.

## Congratulations!



**Your new WeatherTech® No-Drill MudFlaps have been installed!**

Your WeatherTech® No-Drill MudFlap carries a Lifetime Warranty against defects in materials and workmanship when installed correctly.

[View Easy Installation Video](http://WeatherTech.com/install)  
[WeatherTech.com/install](http://WeatherTech.com/install)

Questions? Call customer service at 630 769 1500  
Monday - Friday: 9 a.m. to 5 p.m. Central Time