

# AlloyGator®

## FITTING INSTRUCTIONS

For best results read these instructions carefully before attempting to fit your AlloyGator. You may also find it useful to go to [www.alloygator.com](http://www.alloygator.com) and watch the short fitting video. AlloyGator can be fitted either with the wheel on the vehicle or removed. You will need the following tools – rubber mallet, plastic pipe cutters or garden pruning secateurs, jack and a way of inflating the tyre – footpump, mini compressor, etc.

**1** Jack up the vehicle according to the owner's handbook, until the wheel is clear of the ground. Then fully deflate tyre by removing the valve core or by using a gripper from the AlloyGator pack, to release the air (**1**).



**2** Identify your wheel size and check the gripper location guide below. The wheel size can be identified from the tyre sidewall eg. 205/55R16. The final two figures are the wheel size in inches ie. 16 inch. Apply a small dab of glue to each gripper location just prior to inserting the gripper (**2**).



**3** Insert the gripper into the AlloyGator, serrated edge first (**3**) following the numbered slots for your wheel size. Ensure the gripper fits flush into the slot and retaining groove. Clip all points starting from the end of the AlloyGator with the hole in until you get to the number 13 slot, then follow the guide below.

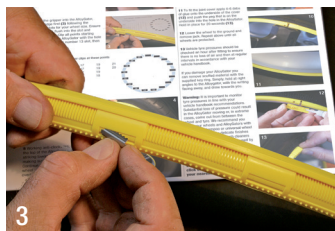

Wheel size	Insert gripper clips at these points			
21"	13	15	17	19
20"	13	15	17	19
19"	13	15	17	19
18"	13	15	17	18
17"	13	15	17	
16"	13	15	16	
15"	13	15		
14"	13	14		
13"	13			

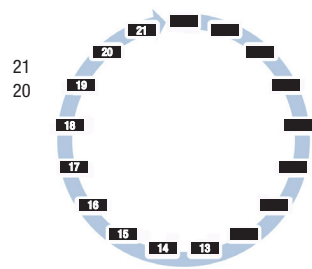

**4** Spray or wipe rim and tyre with mild soapy water – a weak car wash solution is ideal. Starting at the valve, insert the end of the AlloyGator with the hole in, between the rim and tyre (**4**) and firmly tap in with mallet.



**5** Working anti-clockwise, firmly tap the top of the AlloyGator with the mallet striking towards the centre of the rim (**5**) making sure it is in as far as it will go. Continue tapping the AlloyGator between wheel and tyre around the rim until it overlaps back at the valve.



**6** Mark the overlapped section in line with the first tooth on the tab end (**6**).

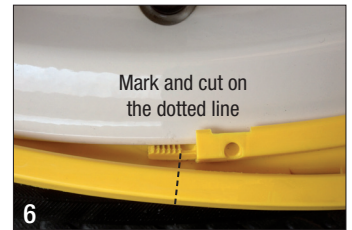

**7** Pull the overlapped end back from the rim and using the cutters or secateurs cut at the mark to remove the excess (**7**).

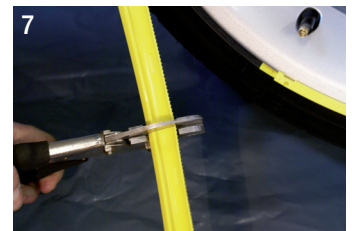

**8** Gently tap the AlloyGator back into position making sure the ends mesh together along the locking teeth (**8**). Before tapping all the way in, run a small amount of glue along the teeth between the two ends (**9**). Firmly tap them into place hitting at a right angle to the wheel to make sure that the ends line up with each other.



**9** Working anti-clockwise, and hitting away from the centre of the rim seat the AlloyGator onto the wheel all the way round (**10**). Do the same for the joint using a square-on blow across both ends at the same time ensuring you apply equal pressure. Avoid hitting one side more firmly than the other. Inflate tyre to 10–15 psi and repeat for another rotation.



**10** Re-inflate the tyre in accordance with your vehicle handbook and again hitting away from the centre of the rim, seat the AlloyGator into its final position. There should be a slight gap but no more than a 1mm between the AlloyGator and the wheel (**11**).



**11** To fit the joint cover apply 4-6 dabs of glue onto the underside of the cover (**12**) and push the peg that is on the underside into the hole in the AlloyGator. Hold in place for 20 seconds (**13**).

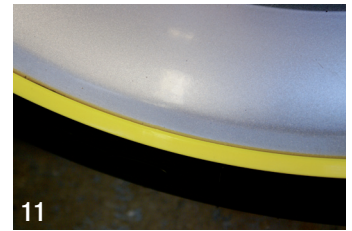

**12** Lower the wheel to the ground and remove jack. Repeat above until all wheels are protected.

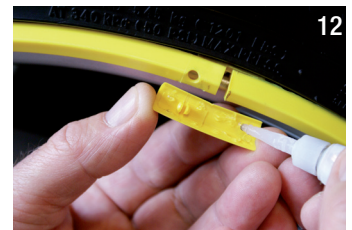

**13** Vehicle tyre pressures should be checked an hour after fitting to ensure there is no loss of air and then at regular intervals in accordance with your vehicle handbook.



If you damage your AlloyGator you can remove scuffed material with the supplied key ring. Simply, hold at right angles to the AlloyGator, with the writing facing away, and draw towards you.

**Warning:** It is important to monitor tyre pressures in line with your vehicle handbook recommendations. Substantial loss of pressure could result in the AlloyGator moving or, in extreme cases, come out from between the wheel and tyre. We recommend you clean your wheels and AlloyGators with normal car shampoo or universal wheel cleaners suitable for delicate finishes like chrome. Avoid the harsh cleaners and thick, brush-on tyre shines used by some hand car washes.

**For professional fitting by our dealer network go to [www.alloygator.co.uk](http://www.alloygator.co.uk) and click on 'find a fitter' for your nearest stockist.**